



I Applications

RV pumps are mainly used in wineries for the pump-over process where the high capacity and minimum destruction of the solid parts in suspension are very important.

I Operating principles

Due to the helical shape of the impeller, the pump lets solid particles pass without destroying their structure, thus, in the phase of vinification, contributing to a better extraction of tannin, the coloring matter of wine, reducing the lees formation and, as the result, achieving high quality wines.

I Design and features

Close-coupled pump.

Helicoidal impeller.

Connections DIN 11851.

Motor: IEC 3 ph 230/400 V Δ 50Hz, IP55, 1450 rpm.

Pump casing with drain port.

High efficiency, low power consumption.

I Materials

Parts in contact with the media: AISI 316L (1.4404)

Investment casting pump casing and adapter

Electropolished surface finish

Mechanical seal (standard): SiC/SiC/EPDM



I Options

- Flushed mechanical seal.
- Connections: SMS, Clamp, Macon, Garolla, FIL, RJT.
- CE electric panel with 10 m cable and plug.
- Stainless steel trolley.
- Remote control.
- Shroud.

I Technical specifications

Max. flow	150 m ³ /h / 660 GPM
Max. operating pressure	1,5 bar / 22 PSI
Max. working temperature	120° C / 248° F
Max. speed	1450 min ⁻¹

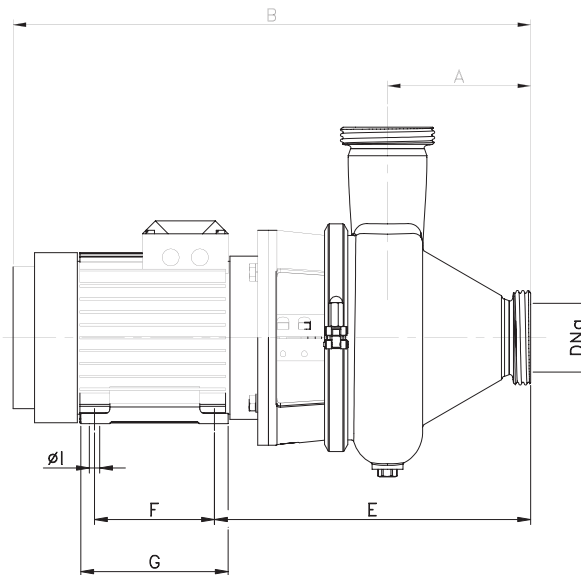
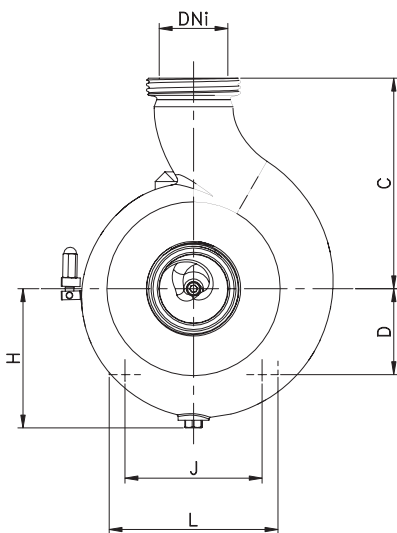

Type	DNa DNi	Flow ⁽¹⁾ m ³ /h	Head m.c.l	Speed R.P.M	Power(kW) (IEC)	A	B	C	D	E	F	G	H	I	J	L	Weight kg	Code
RV-65	65	30	4	1500	0,75 (80)	120	458	215	80	283	100	125	130	10	125	154	24	8RV65B4007
RV-80	80	85	5		2,2 (100)	167	604	245	100	639	140	172	162	12	160	197	50	8RV60D4022
RV-100	100	125	5		4 (112)	189	647	280	112	406	140	172	186	12	190	230	57	8RV100E4040

(1) For clean water at 20° C.

